

# IR DOME CAMERA USER MANUAL

## 960H Ultra Resolution Series



The product image may differ from the actual product.  
It's recommended to use this camera with a DVR which supports 960H video recording.  
Please read the instructions thoroughly before using the product.

### PACKAGE CONTENT

1. Camera
2. User Manual

### FEATURES

1. 1/3" H.R. Color CCD
2. 700 TVL superior image quality
3. Low light sensitivity of 0.1 Lux / F2.0, 0 Lux (IR ON)
4. Day and night features for 24-hour surveillance
5. IR effective range up to 15 meters

### SPECIFICATIONS\*

Model	IR Dome Camera
Pick up Element	1/3" HR color CCD image sensor
Number of Pixel	976(H) x 494(V) <NTSC> / 976(H) x 582(V) <PAL>
Resolution	700 TVL
Min. Illumination	0.1 Lux / F2.0; 0 Lux (IR ON)
IR LED	21 units
IR Effective Distance	Up to 15 meters
S/N Ratio	More than 48dB (AGC off)
Electronic Shutter	1/60 (1/50) to 1/100,000 sec.
Lens	f3.6 / F2.0
Lens Angle	98.3° (Diagonal) / 76.3° (Horizontal) / 56.2° (Vertical)
Iris Mode	AES
White Balance	ATW
Video Output	1.0Vp-p composite, 75Ω
Operating Temperature	0°C~40°C
Power Source (10%)	DC12V
Current Consumption (10%)	70mA (IR OFF), 200mA (IR ON)
Dimension (mm)**	94.1(Ø) × 70.7 (H)

\* The specifications are subject to change without notice.

\*\* Dimensional Tolerance: ± 5mm

## INSTALLATION

1. Open the packet and select the location where you would like to install the dome camera. Take the mounting bracket off the dome camera.
2. Slightly drill the supplied three screws into the three round holes on the mounting bracket and rotate the bracket clockwise until the screws are wedged into the narrower chase (as shown in Figure 1). Tighten the fixing screws to secure the mounting bracket to the ceiling.
3. Drill a hole in the middle circle and let the power and video line go through (as shown in Figure 2).
4. Mount the dome body onto the mounting bracket and rotate it until it clicks to secure (as shown in Figure 3). Adjust the camera to the correct position and test the dome camera to make sure it is working properly.

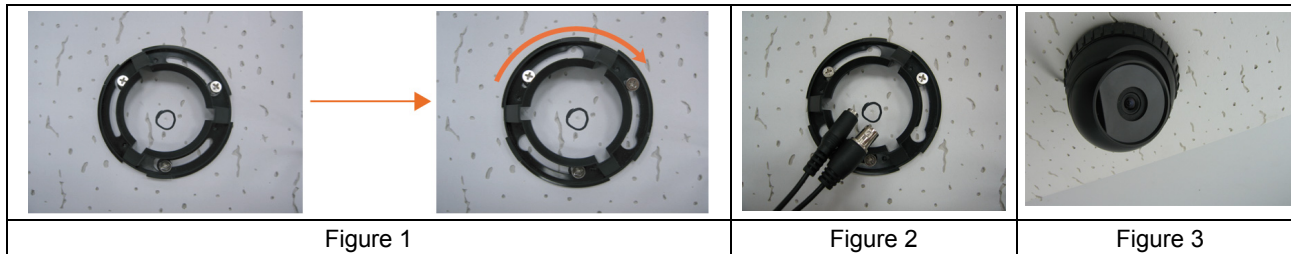

## CONNECTION

### 1. DC12V Input Terminal

Connect the power terminal of the camera to a DC 12V regulated power supply.

**NOTE:** Please use the correct power adaptor, DC12V (regulated), to operate this unit. The power tolerance of this unit is DC12V  $\pm$  10%. Over maximum DC 12V power input will damage this unit.

### 2. Video Output Connector (VIDEO OUT)

Connect the camera video output to the video input of a DVR with 75 $\Omega$  coaxial cable.



### CAUTION

**RISK OF ELECTRIC SHOCK**



#### CAUTION:

To reduce the risk of electric shock, do not expose this apparatus to rain or moisture.

Only operate this apparatus from the type of power source indicated on the label.

The company shall not be liable for any damages arising out of any improper use, even if we have been advised of the possibility of such damages.



The lightning flash with arrowhead symbol, within an equilateral triangle, is intended to alert the user to the presence of uninsulated "dangerous voltage" within the product's enclosure that may be of sufficient magnitude to constitute a risk of electric shock to persons.



This exclamation point within an equilateral triangle is intended to alert the user to the presence of important operating and maintenance (servicing) instructions in the literature accompanying the appliance.



ROHS Announcement

All lead-free products offered by the company comply with the requirements of the European law on the Restriction of Hazardous Substances (RoHS) directive, which means our manufacture processes and products are strictly "lead-free" and without the hazardous substances cited in the directive.



The crossed-out wheeled bin mark symbolizes that within the European Union the product must be collected separately at the product end-of-life. This applies to your product and any peripherals marked with this symbol. Do not dispose of these products as unsorted municipal waste.



CE Mark

This apparatus is manufactured to comply with the radio interference.

The company does not warrant that this manual will be uninterrupted or error-free. We reserve the right to revise or remove any content in this manual at any time.